



6W (1/124 HP)

REVERSIBLE MOTORS Frame size 61mm sq. (2.4 in.sq.)

Single-Phase

LEAD WIRE TYPE

SPECIFICATIONS

CONTINUOUS DUTY, INSULATION CLASS A or E, 4POLES

Model	Output		Voltage (V)	Frequency (Hz)	Rated						Starting Torque			Capacitor (μ F)
	(HP)	(W)			Input (W)	Current (A)	Torque			Speed (rpm)	(kg-cm)	(N-m)	(oz-in)	
							(kg-cm)	(N-m)	(oz-in)					
L6R6□C	1/124	6	1 \varnothing 100	50 60	25 25	0.22 0.22	0.49 0.38	0.048 0.037	6.80 5.28	1200 1550	0.52 0.52	0.051 0.051	7.22 7.22	3.5
L6R6□D	1/124	6	1 \varnothing 200	50 60	25 25	0.12 0.12	0.49 0.38	0.048 0.037	6.80 5.28	1200 1550	0.52 0.52	0.051 0.051	7.22 7.22	1
L6R6□B	1/124	6	1 \varnothing 220	60	30	0.13	0.38	0.037	5.28	1550	0.55	0.055	7.64	0.8
L6R6□E	1/124	6	1 \varnothing 115	60	25	0.25	0.38	0.037	5.28	1550	0.5	0.049	6.94	3
L6R6□X	1/124	6	1 \varnothing 220~240	50	30	0.14	0.47	0.046	6.53	1250	0.64	0.063	8.89	1

- * Model in grey screen represents the motors with IMPEDANCE PROTECTED according to UL regulation.
- * Model in dark grey screen represents the motors with IMPEDANCE PROTECTED according to CE regulation.
- * In case of some models certificated for export, the special cord like CE or UL is added after the existing model no. ex) L9160□XH-CE, L9160□EH-UL.
- * Insulation class for motors which acquired certificates for export is B.

REVERSIBLE MOTORS

DIMENSIONS

L6R6P□L

Unit : mm(inch)

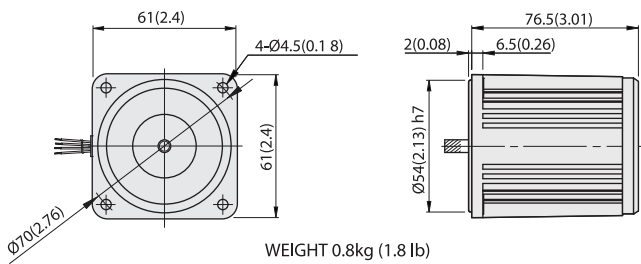

WEIGHT 0.8kg (1.8 lb)

L6R6D□

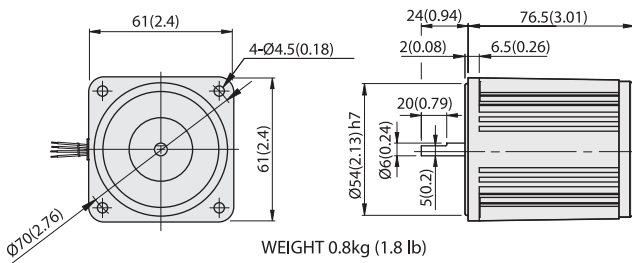

WEIGHT 0.8kg (1.8 lb)



SPEED-TORQUE CURVE

Single phase L6R6□□

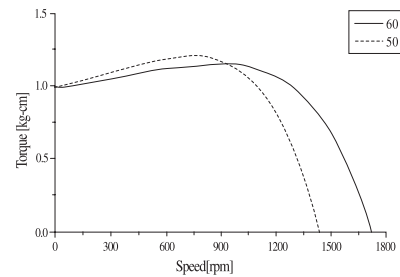

CONNECTION DIAGRAMS

Standard or with T.P

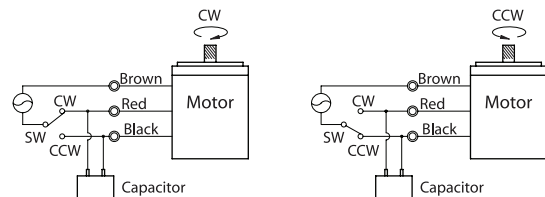

The direction of rotation is seen from the end of motor shaft.